

FOR LEASE

High Traffic Retail/Office Suites

LENA BERCH

805.680.2279

Lena@BattagliaRE.com

CA Lic #00864783



- Excellent visibility
- Picturesque and inviting courtyard
- Flexible configurations
- Ideal for gifts, clothiers, wine tasting, and restaurants

485 Alisal Rd

SOLVANG, CA

Retail suites available in excellent downtown location on busy corner of Alisal Road and Mission Drive in Danish town of Solvang. Highway frontage with 19,000 car trips per day on Mission Drive and high volume pedestrian traffic. Beautifully landscaped and a great tenant atmosphere. Competitive lease rates, call for details.

PROPERTY DETAILS

Zoning	TRC (Tourist Related Commercial)
Renovated	2007
Restrooms	Common & Private
Parking	16 spaces on-site plus public lot across street
Elevator	Yes

805.688.5333

www.BattagliaRE.com

2901 Grand Ave #D, PO Box 540, Los Olivos, CA 93441-0540

Information contained herein was obtained from sources believed reliable. While we do not doubt its accuracy, we do not guarantee it. Buyer to independently verify.



FOR LEASE: 485 Alisal Rd, Solvang, CA



Information contained herein was obtained from sources believed reliable. While we do not doubt its accuracy, we do not guarantee it. Buyer to independently verify.

FOR LEASE: 485 Alisal Rd, Solvang, CA

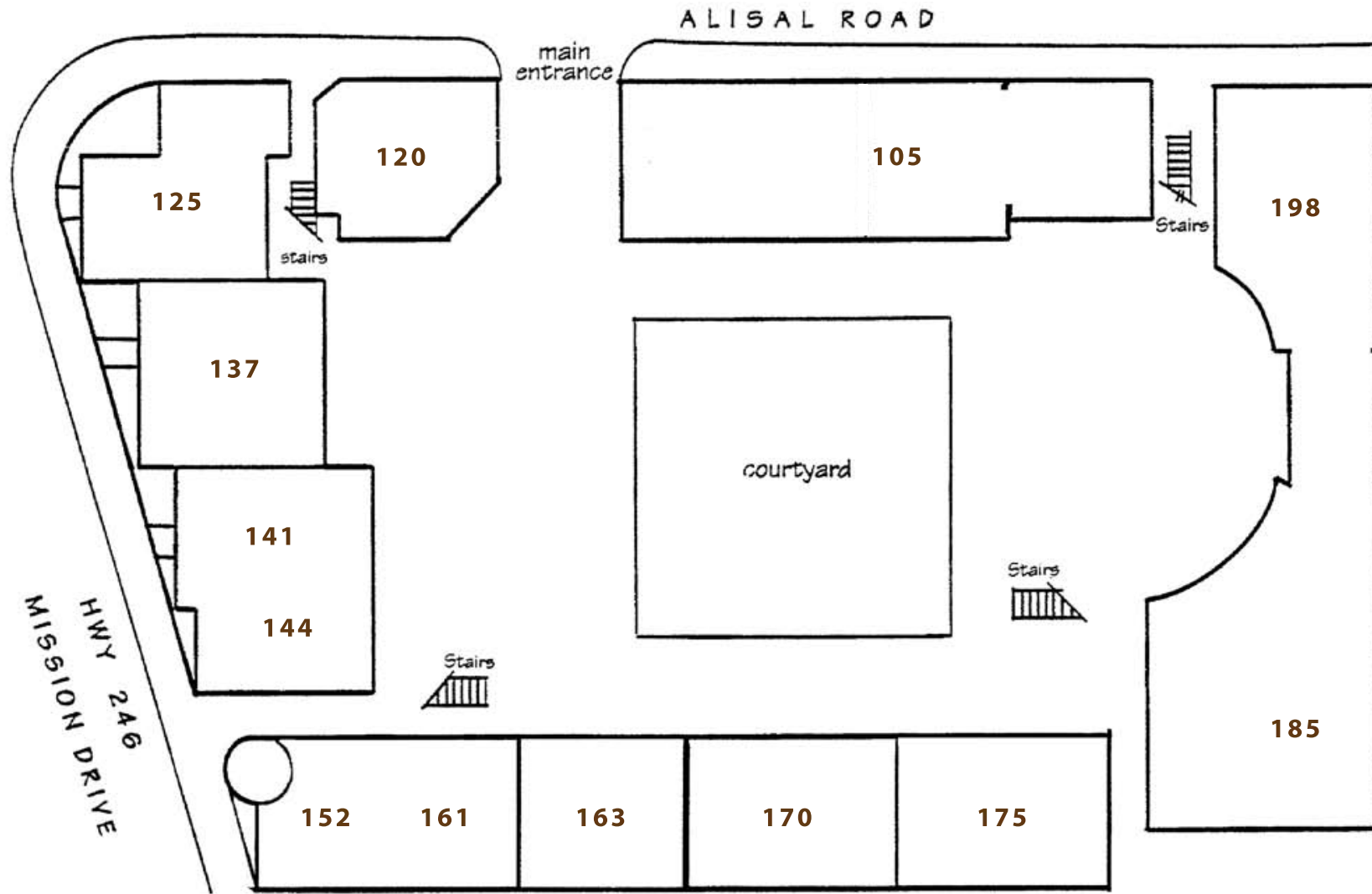

First Floor
Not to scale

FREDERIK'S COURT
485 Alisal Road
Solvang, CA 93463

Information contained herein was obtained from sources believed reliable. While we do not doubt its accuracy, we do not guarantee it. Buyer to independently verify.

FOR LEASE: 485 Alisal Rd, Solvang, CA

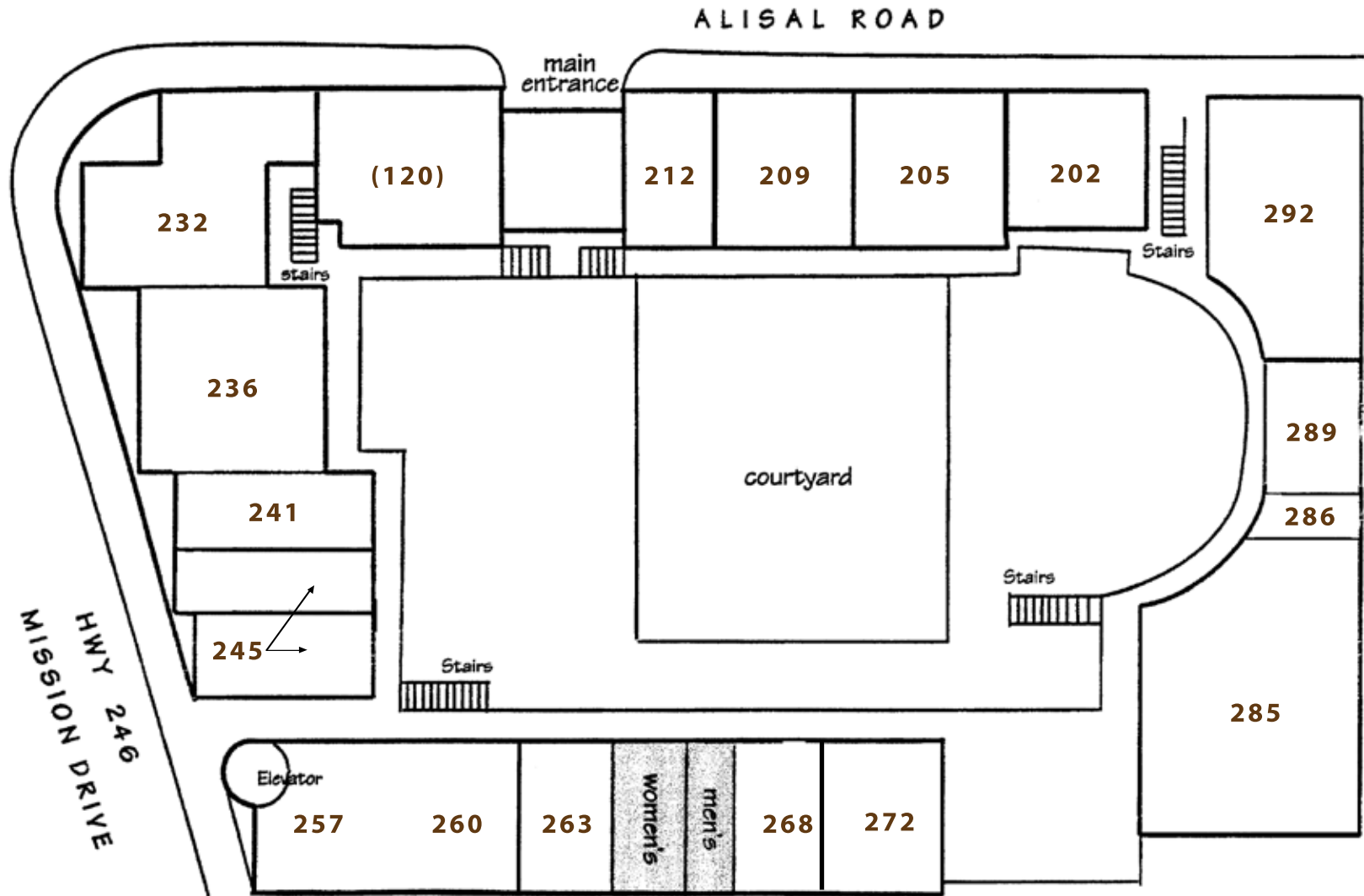

Second Floor
Not to scale

FREDERIK'S COURT
485 Alisal Road
Solvang, CA 93463

Information contained herein was obtained from sources believed reliable. While we do not doubt its accuracy, we do not guarantee it. Buyer to independently verify.